

PRODUCT NUMBER
71959-YXXLF

WHEN REQUIRED, ADD SUFFIX LETTER "LF"
INDICATES THE PRODUCT IS RoHS
COMPATIBLE, SEE NOTE 7

PLATING

3=0.76µm GOLD/GXT ON CONTACT AREA
3.81µm TIN-LEAD ON TAIL

4=3.81µm TIN-LEAD ON CONTACT AREA
AND ON TAIL

WHEN "LF" IS REQUIRED, 2µm MIN
MATTE TIN OVER 1.27µm MIN NICKEL
IS PROVIDED INSTEAD OF TIN-LEAD

STYLE	SIZE	OMIT PIN POSITION FROM TOP VIEW
01	1x03	1
02	1x03	2
03	1x03	3
04	1x07	3;4;5
05	1x04	2;3

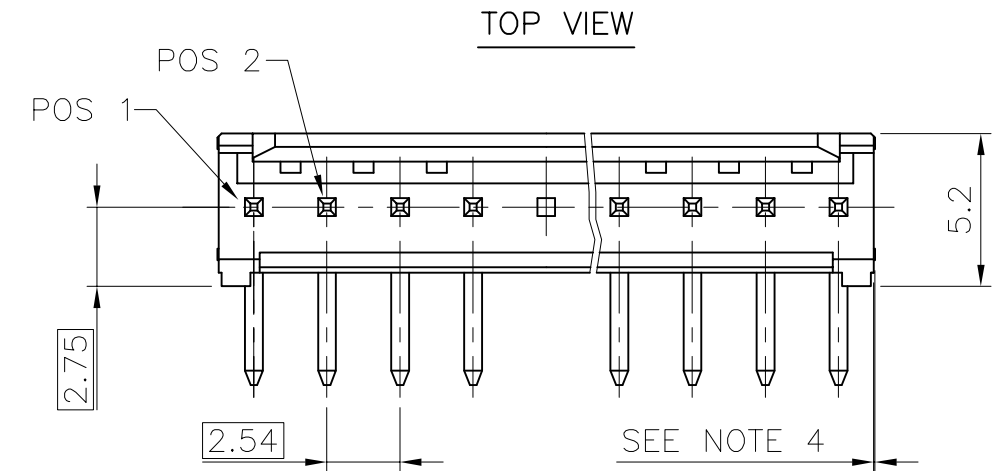

NOTES:

1. BODY MATERIAL: POLYESTER 30% GLASSFILLED COLOR BLUE, FLAME RETARDANT PER UL-94 V0.
2. CONTACT MATERIAL: PHOSPHOR BRONZE.
3. 22N MIN PIN RETENTION IN EITHER DIRECTION
4. 0.6 MAX PROTRUSION PERMITTED AT 4 PLACES
5. PACKAGING :
- POLYBAGS FROM 02 TO 06 POSITIONS
- TUBE FROM 07 TO 36 POSITIONS
6. TO DETERMINE DIMENSIONS :
N = NUMBER OF POSITIONS PER ROW
EXAMPLE : 8 POS N x 2.54 = 20.32mm
7. RoHS COMPATIBLE PRODUCT SPECIFICATIONS

- a - PLATING:
- "LF" MEANS THE PRODUCT IS LEAD-FREE,
2µm MINIMUM MATTE TIN OVER 1.27µm
MINIMUM NICKEL UNDERPLATE.
- b - MANUFACTURING PROCESS COMPATIBILITY
- THE HOUSING WILL WITHSTAND EXPOSURE TO
245°C ±5°C SOLDER BATH TEMPERATURE FOR
5 SECONDS IN A WAVE SOLDER APPLICATION
WITH A 1.6mm MIN THICK CIRCUIT BOARD.
- c - LABELING:
- MEETS PACKAGING SPECS AS PER GS-14-920
- d - LEGAL STATEMENT: SEE GS-22-008

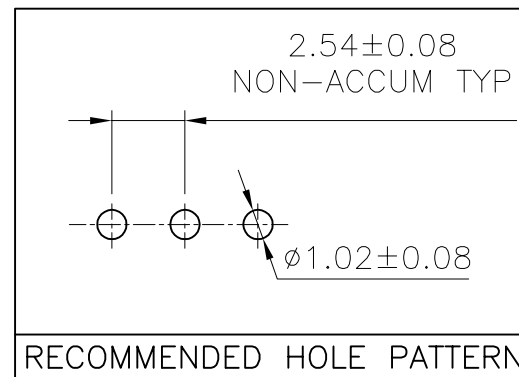
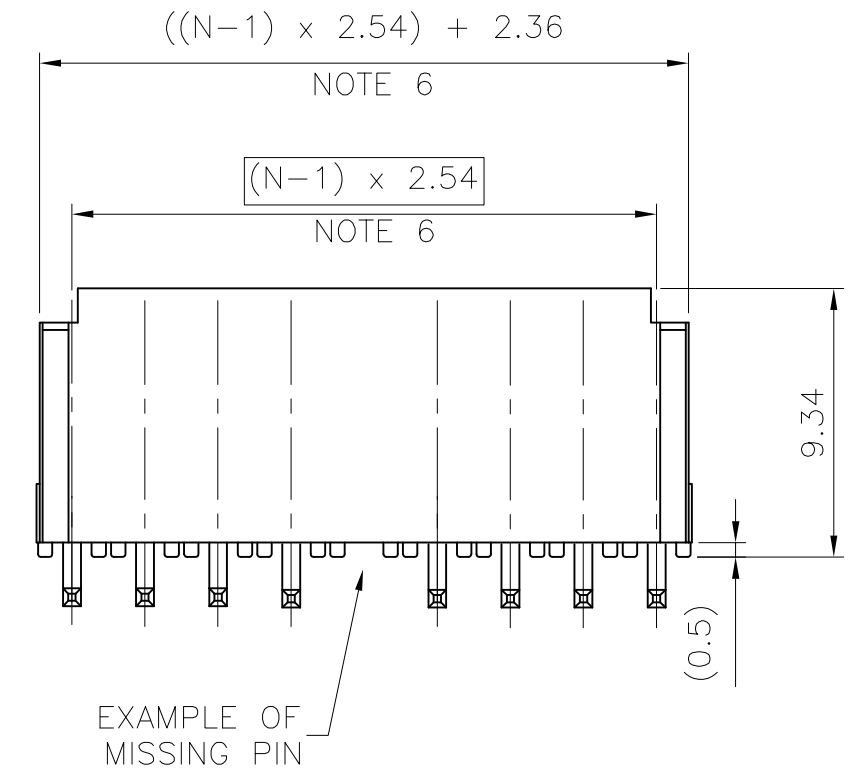
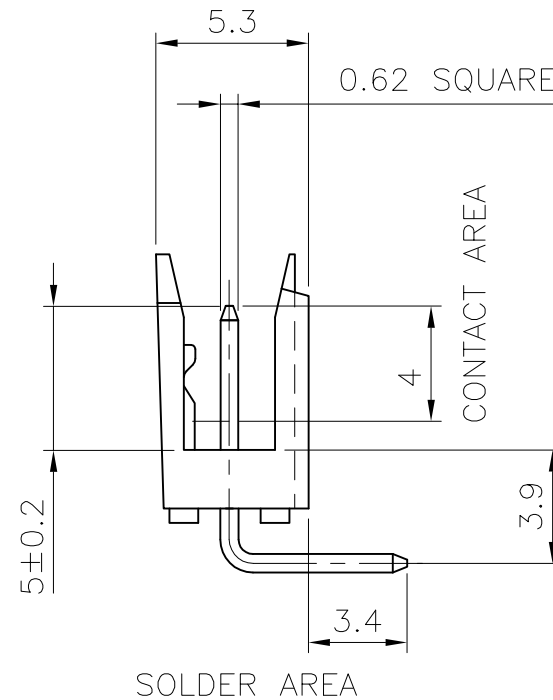

mat'l. code SEE P/N				surface ISO 1302 ✓		tolerance ISO 406 ISO 101		projection mm		product family DUBOX HDR	
ltr	ecn no	dr	date	tolerances unless otherwise specified		.X ±0.3		mm		title DUBOX,SR,RA SELECTIVELY LOADED	
H	F08-0147	YOV	08.04.14	angles		.XX ±0.15		scale 4:1		sheet 1 of 1	
C	F70676	PNZ	97.11.19	linear		.XXX ±0.05		FCJ		size A3	
D	F05-0117	LMU	05.01.26	dr	COMPAGNON J	95.04.11		71959		type CUSTOMER Drawing	
E	F05-0156	LMU	03.05.22	enr	PHAMVAN JM	95.04.11					
F	F05-0244	JCO	05.09.06	chr	JMC	95.04.11					
G	F06-0228	LMU	06.07.11	appd	JMP	95.04.11					
sheet index		revision sheet									